

In The News | 30th May 2023 | Latest Rail News

May 30, 2023

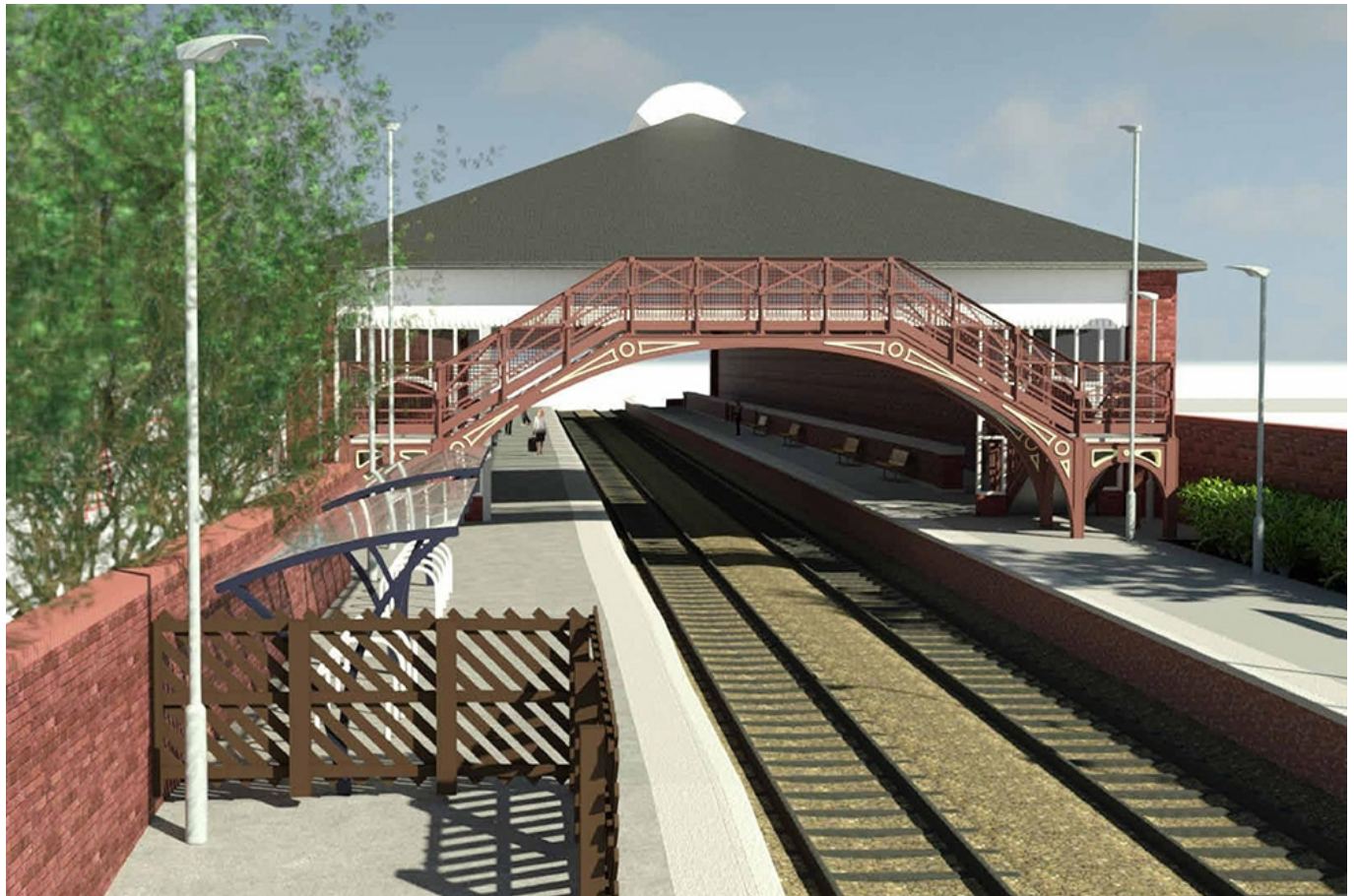

Click here to listen to the latest rail news on Tuesday, 30th May 2023

InTheNews: The latest rail news on Tuesday, 30th May 2023

The Flying Scotsman is reportedly at risk of being forced off mainstream rail lines over demands for its carriage door locks to be updated.

According to an article on the Mail Online, under new regulations imposed by the rail watchdog, it and other historic locomotives are required to have central locking to improve safety.

The 100-year-old Flying Scotsman's doors are currently locked and unlocked with an old-fashioned bolt.

Train bosses are reportedly resisting pressure from the Office of Rail and Road (ORR) to modernise the carriages with a central door locking system.

The ORR argued that centrally-controlled locking systems prevent passengers from opening doors when the platform is too short, according to The Daily Telegraph.

Train services connecting Oxford, Milton Keynes and Cambridge have moved a step closer as East West Railway Company (EWR Co) published its latest proposals for East West Rail (EWR).

The EWR update is part of a wider government announcement the Chancellor of the Exchequer made about plans to bolster the UK's position as a global science superpower.

The updated proposal includes a route alignment that best serves the Cambridge Biomedical Campus and a new station near Tempsford.

[Click here for more details.](#)

Oldham's politicians have called for better after the government announced a £72 million investment in rail.

An article on the Oldham Times website says the announcement promises improved railway services in Greater Manchester, with upgraded track in north Manchester, a third platform at Salford Crescent, and extra entry and exit points at Manchester Victoria, which also serves Oldham's tram line.

However, the announcement also sees the cancellation of decade-old plan to build two more platforms at Manchester Piccadilly.

The addition of platforms 15 and 16 at what is Britain's fourth busiest railway station outside London was designed to ease severe congestion.

Work is due to get under way later to repair and restore a 130-year-old East Yorkshire railway footbridge.

An article on the BBC website says the Grade II-listed structure at Beverley Station has been closed since September due to safety concerns.

As part of the work, a wooden canopy is to be removed, despite objections from Beverley Civic Society and members of the public who wanted it restored.

Network Rail said there was a "risk of pieces of the weakened canopy falling onto the tracks below".

Photo credit: Network Rail